

hS hayat secret[®]

mind, body, soul & beyond

product manual - (Omega)



Unravelling the secrets of nature to nurture the mind, body and soul



info@hayatsecret.com

product manual

product overview

01 Specification

- 【 Size 】 371*260*100mm
- 【 Bottle 】 1000ml
- 【 Input 】 DC12V= 1A MAX/1A MAX/2A MAX
- 【 Power 】 10W
- 【 Coverage 】 800m³/2400m³/85000ft³
- 【 N.W. 】 4.5kg
- 【 Material 】 metal, glass

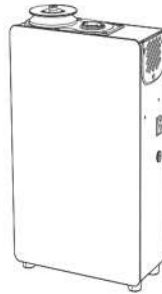

PTFE tape: 1. Tie up/ twine the atomized core when change a new one to machine.
2. Twine connector screwing to machine.

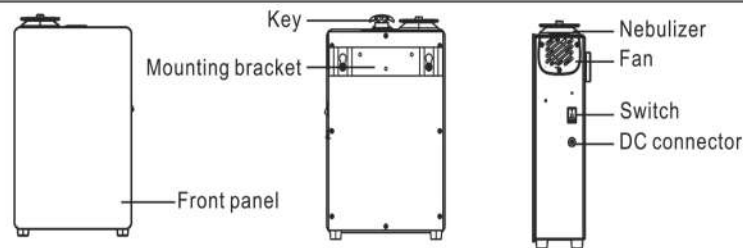

260mm

100mm

371mm

Omega Device

product manual

02 Bluetooth instruction

Where to get the app:

Please Search "Hayat Secret" in Google Play or App Store.

Note:

1. Please make sure that the Bluetooth function is turned on;
2. Please make sure that the location function of the mobile phone is turned on.



Consumption: This value is calculate based on one hour of continuous machine work with 13 mPa.s aroma oil of our company. But aroma oils with different viscosities have varied consumption rates, you can calibrate it via app.

Aroma oil: The amount of aroma oil added to bottle.

Remaining: This refers to how long the aroma oil can be used based on consumption, aroma oil, grade, and working periods.

Turn ON/OFF the device
Turn ON/OFF the fan

Calibrate: It is used for calibrating consumption. It is advised to calibrate after working for at least 10 days. Please measure the remaining oil of bottle first, then tap "calibrate" in the APP, input the amount of remaining oil, and confirm. So the consumption, remaining day, and percentage will be updated.

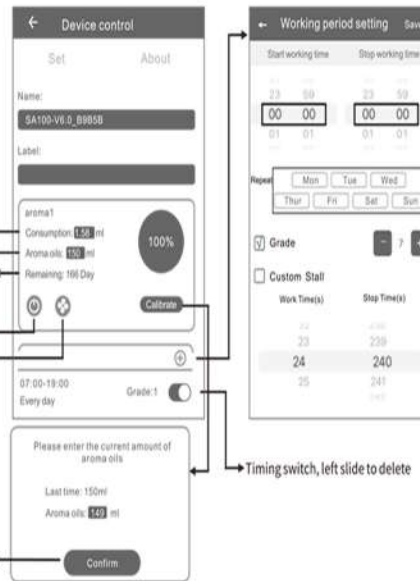

Amend password

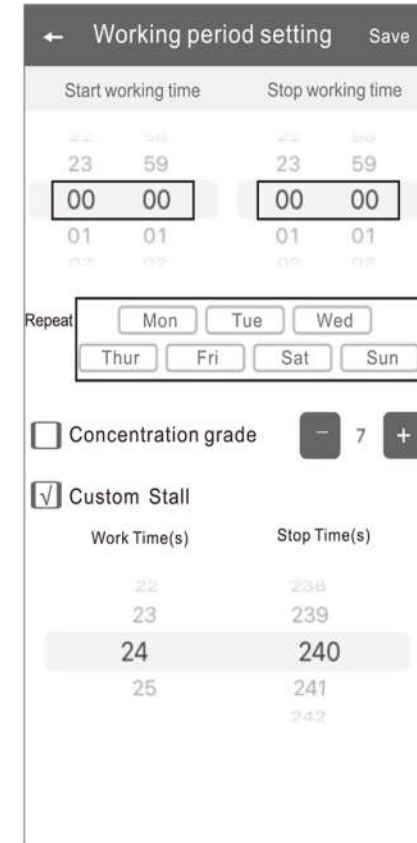

Slide up and down to adjust

Select the day

Select grade

If you forget the password, please press the reset button to restore the factory setting. The factory settings password is 8888.

Hayat Secret App



product manual

03 Installation method

Ideal for Hotels, Conference Rooms, Malls, Exhibition Halls, Major retailers, Bars, SPAs, Business places or anywhere you want a fragrance experience.

Bottle installation steps:

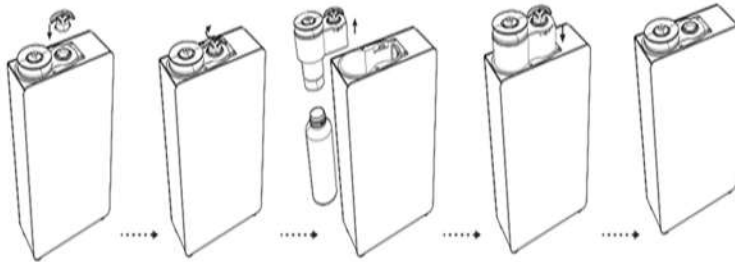

1. Insert the key.
2. Rotate the key clockwise to unlock.
3. Unscrew and take out the atomized head, then fill with fragrance .
4. Insert the atomized head and bottle.
5. Take out the key.

Mount to the wall:

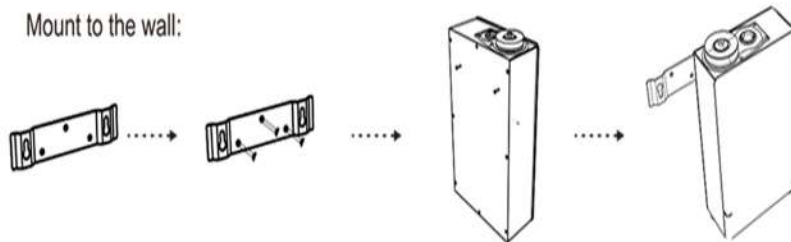

1. align the bracket and drill holes in the wall .
2. Press the expansion tubes into the wall holes, and wall mount the bracket with screws.
3. Screw in the back of the machine.
4. Attach the machine to the bracket.





04 Concentration and consumption

Grade	Consume(g/h) (1000ml bottle)	Concentration	
		Working(s)	Stop(s)
G1	0.3	15s	300s
G2	0.4	15s	150s
G3	0.6	20s	120s
G4	0.7	20s	85s
G5	0.8	25s	80s
G6	1.0	30s	75s
G7	1.1	30s	60s
G8	1.2	30s	50s
G9	1.3	30s	40s
G10	1.5	30s	33s
G11	1.7	33s	30s
G12	1.9	40s	30s
G13	2.2	50s	30s
G14	2.4	60s	30s
G15	2.6	75s	30s
G16	2.8	80s	25s
G17	3.0	85s	20s
G18	3.3	120s	20s
G19	3.5	150s	15s
G20	5.0	300s	15s
Customize	—	5-500s	5-500s

Note: The data shown above is only for reference, and it is normal for consumption to fluctuate by 15%.

product manual

05 Caution

-  Shall not modify, disassemble or repair the machine arbitrarily. Any failure happens, please contact relevant technician in time.
-  Shall not damage the power cord, force to bend, yank, heavy load, clip or reprocess.
 - Shall not use the AC plug when it is damaged or un-matched with the socket;
 - Shall not wet the machine or the AC plug;
 - Shall not use overloaden power socket, wire or broken plug.
-  Shall not touch the wire or product shell when thundering or/and lightning.
-  Shall not disassemble the machine when it is under operating.

Warning:

- After installation, please keep the machine vertical, tilting or laying the machine flat will cause oil leakage and damage to the machine.
- Do not refit, disassemble or repair the machine if you are not technician. If the machine breaks down, please contact our technicians for help.
- It is invalid to touch/tap button when machine is under lock status.
- If the machine programs crashes or other abnomal condition occurs, please restart the machine to restore factory setting (method: press ENT key about 5 minutes until you hear " beep" sound)



06 Troubleshooting

Before asking to have the machine repaired, please try to diagnose the problem first following to bellow instructions.

Symptom	Remedy
Does not diffuse	-Check the power is on or off ; -If the machine is in "not working period", it stops diffuse; -The pump is damaged, change a new one.
Spray little	-Atomized nozzle may be blocked, diffuse with alcohol to do cleaning ; -Pump is aging, change a new one.
Spray liquid	-Atomized nozzle is damaged, change a new one; -Machine is tilted or lay flat, please make it stand onend.
Oil spill	-Bottle is loose, screw it to the right place.
Abnormal sound	-Pump is loose, install it correctly.

07 Equipment cleaning

Diffuser should be cleaned regularly, timing recommendations below:

1. Refilling / changing fragrance in reservoir.
2. Scenting strength becomes weak.
 - Turn off Scenting Diffuser before cleaning.
 - Place clean bottle with small quantity of "Methylated Spirits" / Industrial alcohol.
 - Turn on Machine and let diffuse for 5 minutes.
 - Turn off power and unscrew cleaning fluid bottle.
 - Replace with fresh fragrance, machine is now ready for diffusing.

hs hayat secret[®]
mind, body, soul & beyond

Thank You For Reading

Unravelling the secrets of nature to nurture the mind, body and soul



info@hayatsecret.com