

hS hayat secret[®]

mind, body, soul & beyond

product manual – (Citadel)



Unravelling the secrets of nature to nurture the mind, body and soul



info@hayatsecret.com

product manual

(Citadel)



BT

01 Specification

- [Size] 195*150*585mm
- [Bottle] 1000ml
- [Input] DC12V == 2A MAX
- [Power] 12W
- [Coverage] 900m²/2700m³/6350ft³
- [N.W.] 3.6kg
- [Material] Plastic, metal

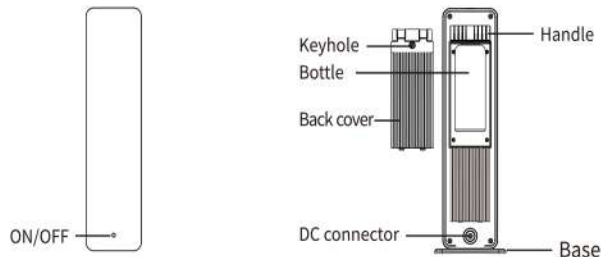
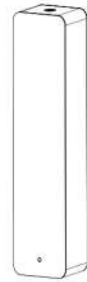

02 Bluetooth instruction

Where to get the app:

Please Search " Hayat Secret " in Google Play or App Store.

Note:

1. Please make sure that the Bluetooth function is turned on;
2. Please make sure that the location function of the mobile phone is turned on.



Consumption: This value is calculate based on one hour of continuous machine work with 13 mPa.s aroma oil of our company. But aroma oils with different viscosities have varied consumption rates, you can calibrate it via app.

Aroma oil: The amount of aroma oil added to bottle.

Remaining: This refers to how long the aroma oil can be used based on consumption, aroma oil, grade, and working periods.

Turn ON/OFF the device
Turn ON/OFF the fan

Calibrate: It is used for calibrating consumption. It is advised to calibrate after working for at least 10 days. Please measure the remaining oil of bottle first, then tap "calibrate" in the APP, input the amount of remaining oil, and confirm. So the consumption, remaining day, and percentage will be updated.

Timing switch, left slide to delete

Hayat Secret App



product manual

Amend password

The image shows two screenshots from a mobile application. The left screenshot is titled 'Device control' and shows a 'Set' button, 'About' button, and version information (PCB, Equipment, APP). A 'Change password' button is highlighted with a downward arrow pointing to a second 'Change password' screen. This second screen has input fields for 'The new password' and 'Confirm password', and a 'Change password' button. The right screenshot is titled 'Working period setting' and shows a table for 'Start working time' and 'Stop working time' with digital time pickers. Below the table are 'Repeat' day selection buttons (Mon-Sun) and 'Concentration grade' (7) and 'Custom Stall' options with a table of work and stop times. Annotations with arrows point to these elements: 'Slide up and down to adjust' for the time pickers, 'Select the day' for the Repeat buttons, and 'Select grade' for the Concentration grade buttons.

If you forget the password, please press the long press the ON/OFF button for 3s to restore factory setting. The factory settings password is 8888.

03 Installation steps

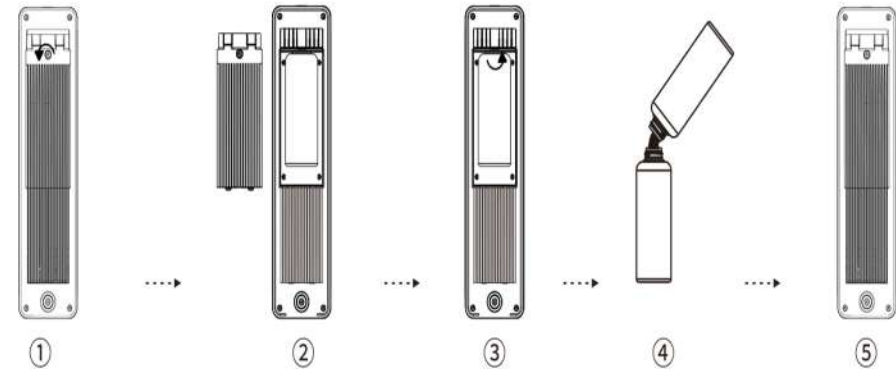

1. Open the back cover with key;
2. Remove the back cover;
3. Twist off the bottle cap;
4. Add fragrance oil into the bottle;
5. Tighten the bottle cap, place the bottle back in the machine, and lock the back cover with a key.

Installation mode:

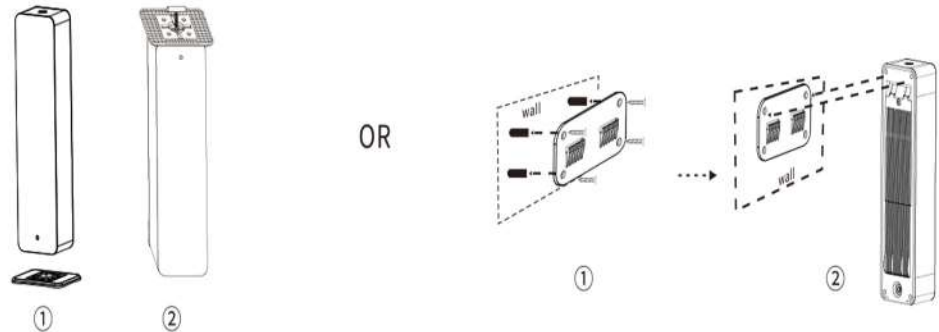

Floor standing:

1. Make sure the base is aligned with the 4 holes at the bottom of the machine, then fix the screws;
2. Align the base with the holes on the bottle of the machine, and secure it with screws.

Wall mount:

1. Drill the 4 screws into wall;
2. Hang the machine to the screws.

product manual

04 Concentration and Consumption

Grade	work(s)	intervals(s)	Consumption(g/h)
G1	15s	300s	0.2
G2	15s	150s	0.4
G3	20s	120s	0.7
G4	20s	85s	1.0
G5	25s	80s	1.2
G6	30s	75s	1.5
G7	30s	60s	1.7
G8	30s	50s	1.9
G9	30s	40s	2.2
G10	30s	33s	2.5
G11	33s	30s	2.7
G12	40s	30s	3.0
G13	50s	30s	3.2
G14	60s	30s	3.5
G15	75s	30s	3.7
G16	80s	25s	4.0
G17	85s	20s	4.2
G18	120s	20s	4.5
G19	150s	15s	4.7
G20	300s	15s	5.0
Customize	5-500s	5-500s	—

PS: 1. The data shown above was obtained based on our testing essential oil.

2. The consumption rate of different essential oils varies, the above data is only for reference, the actual data may prevail.

05 ⚠ Warning

1. Please keep the machine vertical after installation. Tilting or lying flat can cause oil to overflow, and the circuit board may be contaminated, which could affect its efficiency.
2. Should not modify, dismantle or repair the machine arbitrarily. Any malfunction occurs, please contact the relevant technician immediately.
3. The machine does not work when it is not in the programmed working period, even the atomization icon is displayed on the screen;
4. When the machine is in lock status, the button can not be operated and there is no any display on screen.



06 Troubleshooting

Before asking to have the machine repaired, please try to diagnose the problems first based on the following instructions.

Breakdown	Solution
Does not diffuse	-To check whether the power switch is turned on. -The machine may not be in the programmed working period; -Air pump may be damaged, please replace a new one; -To check whether the tube is loose or not.
Weak diffuse	-The atomizing core may be blocked, please clean it by alcohol or replace a new component; -The gasket may be damaged/loose; -The air tube may be loose.
Oil leakage	-To check whether the bottle is loose or not. -The gasket in the atomizer head may be damaged or loose.
Oil sprinkle	-The atomized head may be damaged, please replace a new one. -To check the machine is tilted or lie down, please keep the machine upright.
Abnormal noise	-The air pump may be loose, please retighten the pump. -The air pump may be damaged, please replace a new one.

07 Equipment cleaning

The machine needs to be cleaned when the following situations happen:

1. You're about to replace another essential oils;
2. The atomization volume becomes weak .

Cleaning steps:

1. Find a clean bottle and fill it with industrial alcohol.
2. Add industrial alcohol into bottle about 15%, and make it diffuse 5 minutes.
3. Airing the atomized head and the bottle.

hs hayat secret[®]
mind, body, soul & beyond

Thank You For Reading

Unravelling the secrets of nature to nurture the mind, body and soul |  info@hayatsecret.com